

1	2	3	4	5	6	7	8				
THIS DRAWING AND THE DATA DISCLOSED HEREIN OR HEREWITH IS NOT TO BE REPRODUCED USED OR DISCLOSED IN WHOLE OR IN PART TO ANYONE WITHOUT THE PERMISSION OF JESS-LINK PRODUCTS CO.,LTD.(JPC)				CUSTOMER DRAWING DRWC-XXXXXX		REV.	ECN NO.	DESCRIPTION	MDF'D	APP'D	DATE
						01		INITIAL DESIGN	Philip	Richard	07/11/2023
						02					
						03					

NOTE:

1. MATERIAL AND FINISH
  - 1.1. SHELL ASSEMBLY: COPPER ALLOY, OUTER SHELL AND COLLET NUT Cr PLATING, OTHER METALLIC COMPONENTS Ni PLATING
  - 1.2. INSULATOR: PEEK
  - 1.3. CONTACT: COPPER ALLOY, GOLD PLATING
2. RoHS COMPLIANCE
3. PART NO.

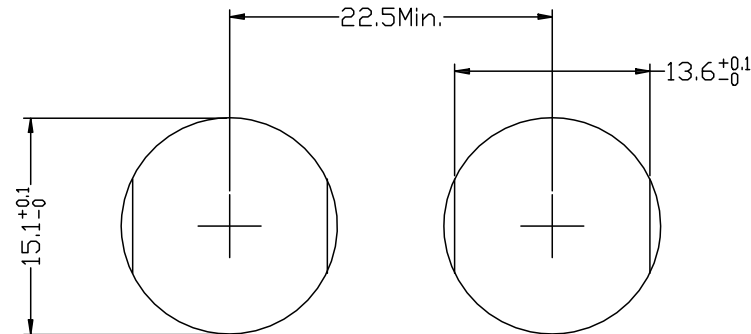

PANEL CUT-OUT

R - F 2 B R \* \* 0 \* 0 0 \* 0 0

CONTACT PDS.
02-32=2pin-32pin

SHELL MATERIAL
0=Brass

CODE	KEY ANGLES
0	0
A	30°
B	60°
..	..

CODE	CONTACT TYPE
2	Male Solder Contact
4	Female Solder Contact

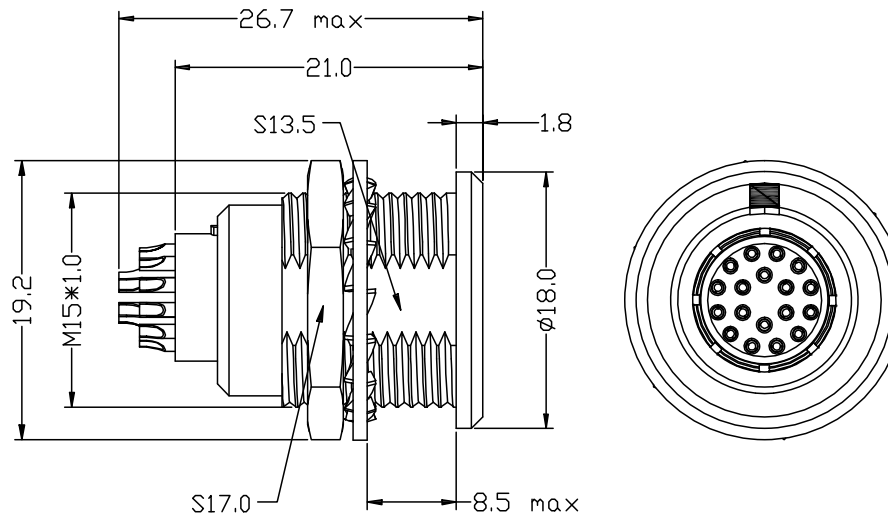

RoHS COMPLIANT	Unit:mm(inch)	PROJECTION	ZCables.com	
	GENERAL TOLERANCES: (UNLESS SPECIFIED)	D.R. 07/11/2023 Philip	TITLE	PD./FILE NO.
	0 =±1 (0.039) 0.0 =±.5 (0.02) 0.00 =±.3 (0.012) 0.000=±.15(0.006)	CH.K 07/11/2023 Philip	B Series , 2B Size , Fixed Socket , 10 Pin , Brass , Female Solder Contact	
	0° =± 2° 0.0° =± 1°	APV.D 07/11/2023 Richard	SCALE SIZE PART NO.	REV. 01
		1:1 A4 PZACF2BXD12101	SHEET 1 OF 4	

1	2	3	4	5	6	7	8				
	THIS DRAWING AND THE DATA DISCLOSED HEREIN OR HEREWITH IS NOT TO BE REPRODUCED USED OR DISCLOSED IN WHOLE OR IN PART TO ANYONE WITHOUT THE PERMISSION OF JESS-LINK PRODUCTS CO.,LTD.(JPC)			CUSTOMER DRAWING DRWC-XXXXXX		REV.	ECN NO.	DESCRIPTION	MDF'D	APP'D	DATE
						01		INITIAL DESIGN	Philip	Richard	07/11/2023
						02					
						03					

view from termination side pin part

2 PDS.

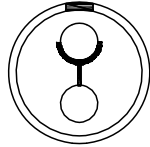

3 PDS.

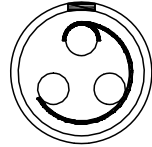

4 PDS.

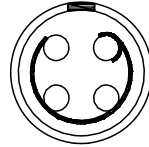

5 PDS.

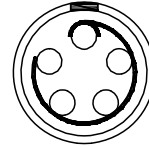

6 PDS.

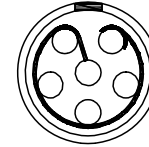

7 PDS.

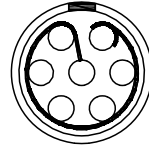

8 PDS.

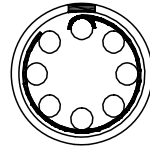

10 PDS.

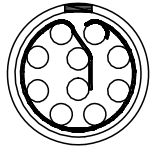

12 PDS.

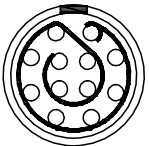

14 PDS.

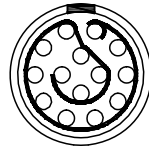

16 PDS.

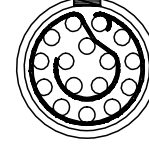

18 PDS.

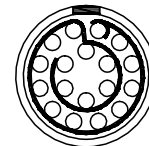

19 PDS.

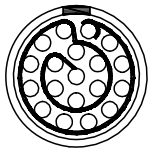

26 PDS.

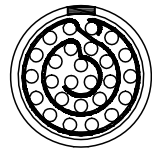

32 PDS.

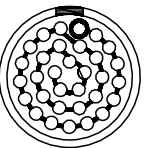

<b>RoHS COMPLIANT</b>	Unit:mm(inch)	PROJECTION 	<b>ZCables.com</b>		
	GENERAL TOLERANCES: (UNLESS SPECIFIED)	D.R. 07/11/2023 Philip			TITLE B Series , 2B Size , Fixed Socket , 10 Pin , Brass , Female Solder Contact
	0 =±1 (0.039)	CH.K 07/11/2023 Philip	SCALE	SIZE	PART NO.
	0.0 =±.5 (0.02)	APV.D 07/11/2023 Richard	1:1	A4	PZACF2BXD12101
0.00 =±.3 (0.012)				REV. 01	
0.000=±.15(0.006)				SHEET 2 OF 4	
0° =± 2'					
0.0° =± 1'					

1	2	3	4	5	6	7	8			
					REV.	ECN NO.	DESCRIPTION	MDF'D	APP'D	DATE
					01		INITIAL DESIGN	Philip	Richard	07/11/2023
					02					
					03					

THIS DRAWING AND THE DATA DISCLOSED HEREIN OR HEREWITH IS NOT TO BE REPRODUCED USED OR DISCLOSED IN WHOLE OR IN PART TO ANYONE WITHOUT THE PERMISSION OF JESS-LINK PRODUCTS CO.,LTD.(JPC)

CUSTOMER DRAWING  
DRWC-XXXXXX

KEY ANGLES (RECEPTACLE FRONT VIEW):

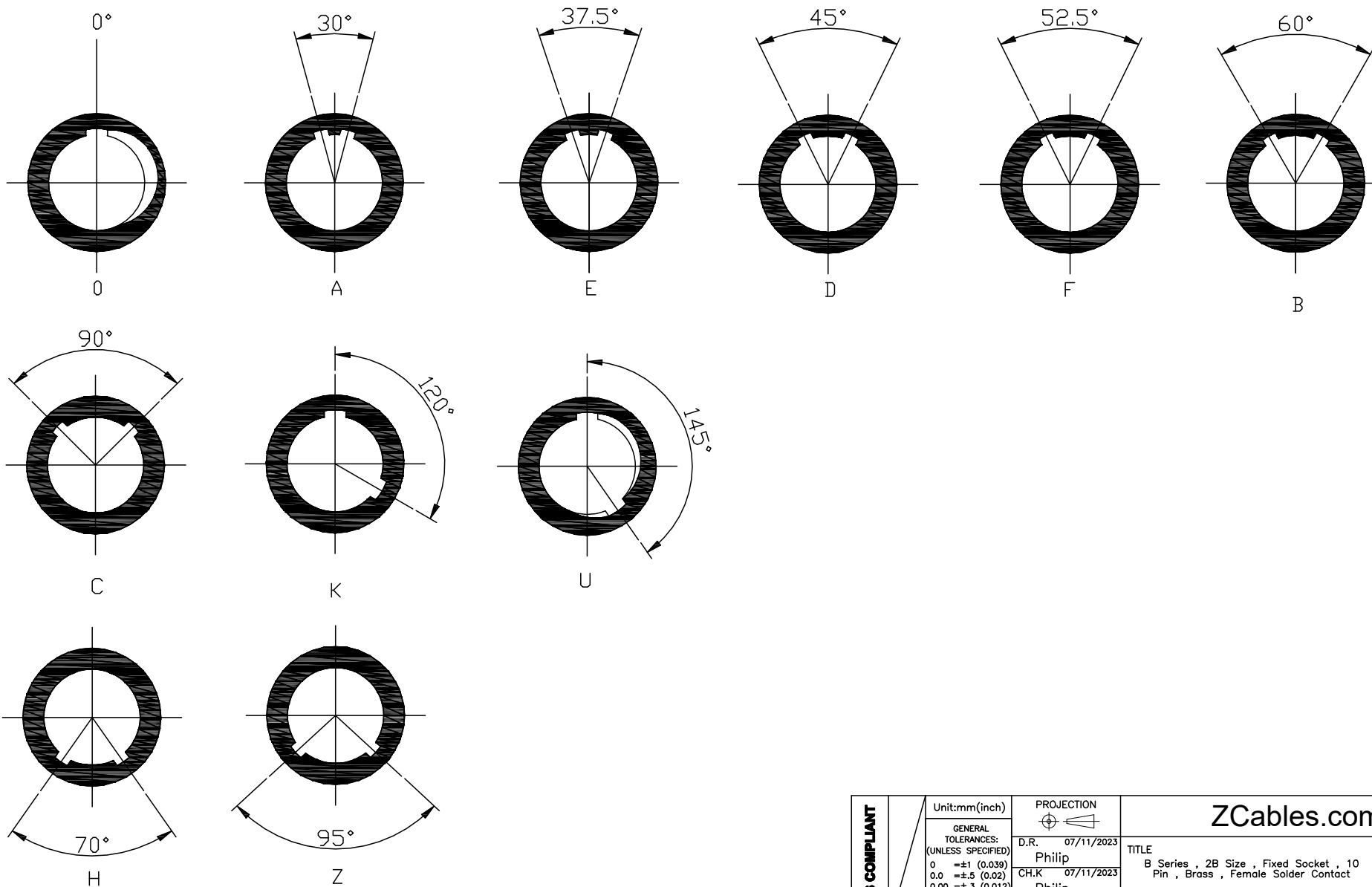

RoHS COMPLIANT	Unit:mm(inch)	PROJECTION 	ZCables.com		
	GENERAL TOLERANCES: (UNLESS SPECIFIED)	D.R. 07/11/2023 Philip			TITLE B Series , 2B Size , Fixed Socket , 10 Pin , Brass , Female Solder Contact
	0 =±1 (0.039)	CH.K 07/11/2023 Philip	SCALE	SIZE	PART NO.
	0.0 =±.5 (0.02)	APV.D 07/11/2023 Richard	1:1	A4	PZACF2BXD12101
0.000=±.15(0.006)				REV. 01	
0° =± 2'				SHEET 3 OF 4	
0.0° =± 1"					

1	2	3	4	5	6	7	8				
THIS DRAWING AND THE DATA DISCLOSED HEREIN OR HEREWITH IS NOT TO BE REPRODUCED USED OR DISCLOSED IN WHOLE OR IN PART TO ANYONE WITHOUT THE PERMISSION OF JESS-LINK PRODUCTS CO.,LTD.(JPC)				CUSTOMER DRAWING DRWC-XXXXXX		REV.	ECN NO.	DESCRIPTION	MDF'D	APP'D	DATE
						01		INITIAL DESIGN	Philip	Richard	07/11/2023
						02					
						03					

PCB Drilling Pattern

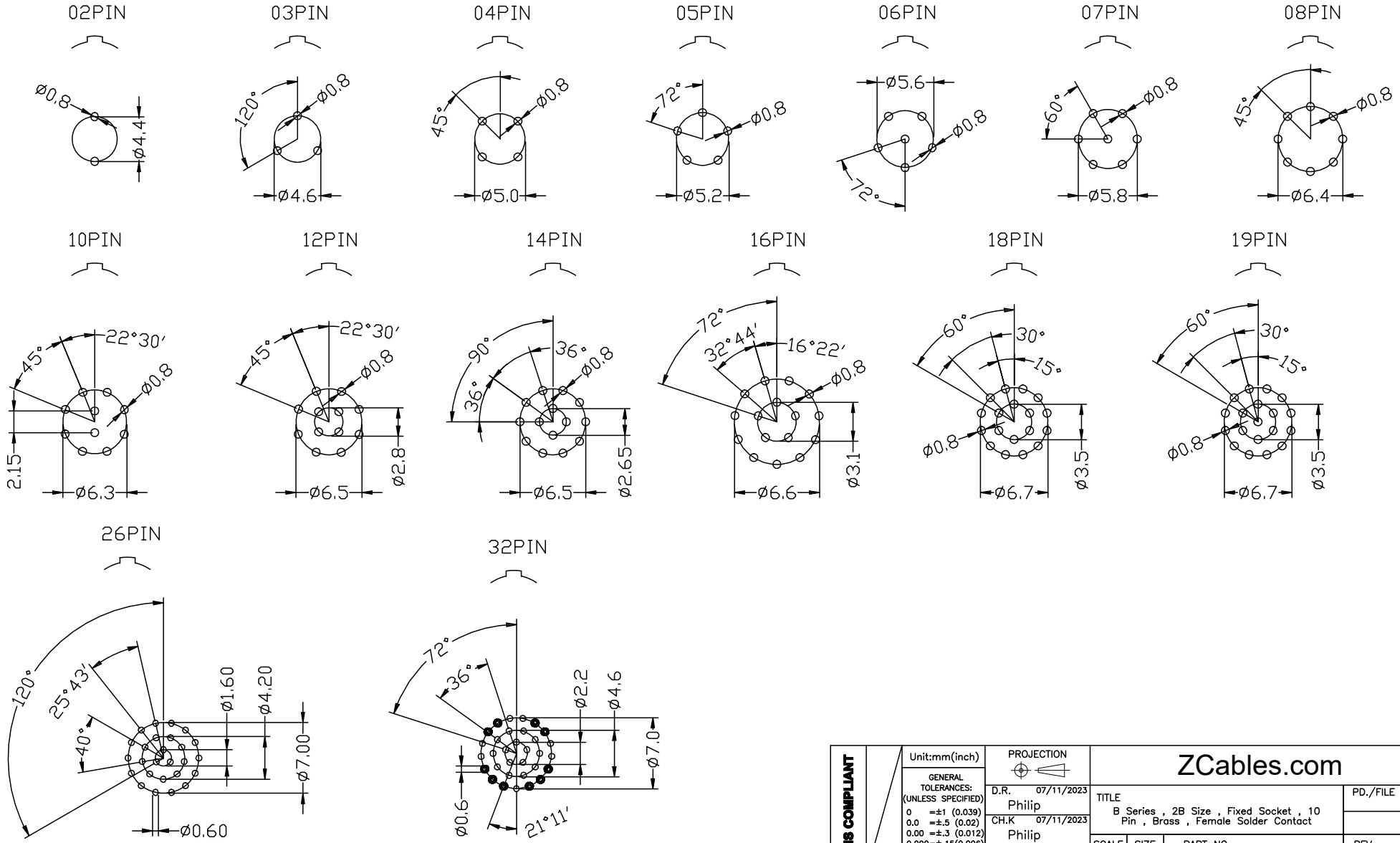

<b>RoHS COMPLIANT</b>	Unit:mm(inch)	PROJECTION 	<b>ZCables.com</b>		
	GENERAL TOLERANCES: (UNLESS SPECIFIED)	D.R. 07/11/2023 Philip	TITLE B Series , 2B Size , Fixed Socket , 10 Pin , Brass , Female Solder Contact	PD./FILE NO.	
	0 = ±1 (0.039) 0.0 = ±.5 (0.02) 0.00 = ±.3 (0.012) 0.000 = ±.15 (0.006)	CH.K 07/11/2023 Philip	SCALE	SIZE	PART NO.
	0° = ± 2° 0.0° = ± 1°	APV.D 07/11/2023 Richard	1:1	A4	PZACF2BXD12101
				REV. 01	
				SHEET 4 OF 4	