

THIS DRAWING AND THE DATA DISCLOSED HEREIN OR HEREWITH IS NOT TO BE REPRODUCED USED OR DISCLOSED IN WHOLE OR IN PART TO ANYONE WITHOUT THE PERMISSION OF JESS-LINK PRODUCTS CO.,LTD.(JPC)

CUSTOMER DRAWING  
DRWC-XXXXXX

REV.	ECN NO.	DESCRIPTION	MDF'D	APP'D	DATE
01		INITIAL DESIGN	Philip	Richard	11/06/2023
02					
03					

POSITIONS	02 PIN	03 PIN	04 PIN	05 PIN	06 PIN	07 PIN	09 PIN
VIEW FROM TERMINATION SIDE PIN PART							

NOTE:

- Material and finish  
Outer shell&Back nut: Copper alloy, Cr plating  
Contact: Copper alloy, Gold plating over Ni  
Insulator: PEEK UL94 V-1  
Gasket: FKM  
Other parts: Copper alloy, Ni plating
- Mechanical characteristics  
Insertion Force: 29.4N MAX.  
Extraction Force: 29.4N MAX.  
Back nut torque: 0.7 N·m MAX.  
Endurance: 5000 mating cycles  
Vibration: 10-2000Hz, 15g comply with EIA-364-28  
Shock: 100g amplitude, half sine pulse of 3ms, no discontinuity > 1us EIA-364-27
- Electrical specifications  
Contact resistance: 8.7 mOhm MAX.  
After 5000 Cycles: 10 mOhm MAX.  
Insulation resistance: >100 Mohm  
Rated current: 2PIN 10.0A (Per Pin)  
3PIN 8.0A (Per Pin)  
4PIN 7.0A (Per Pin)  
5PIN 6.5A (Per Pin)  
6PIN 2.5A (Per Pin)  
7PIN 2.5A (Per Pin)  
9PIN 2.0A (Per Pin)
- Characteristics  
Waterproof level: IP68 (Mating)  
Operating temperature: -55°C ~ + 200°C  
Corrosion resistance: 144 H salt mist, 5 % salt solution, 35°C  
Humidity: 21 days at 95%
- Max Wire Size (AWG) : #22 MAX. for 2&3pin,  
#24 MAX. for 4&5pin,  
#28 MAX. for 6&7&9pin
- RoHS compliance

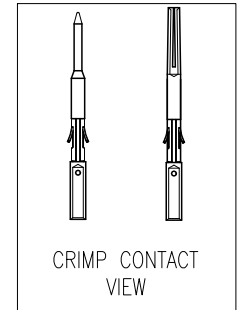
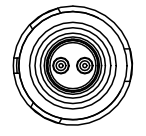
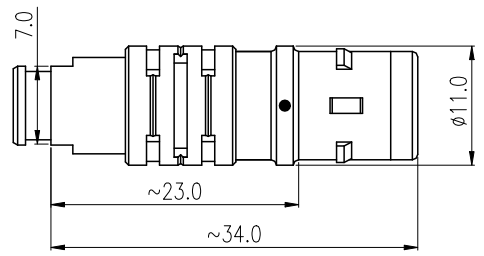

PART NO: R - F O K S 0 6 0 2 C 1 0 5 0

CONTACT POS.	02-09=2pin-09pin
SHELL MATERIAL	0=Brass
CODE	CONTACT TYPE
2	Male Solder Contact
4	Female Solder Contact
C	Crimp Male Contact
M	Crimp Female Contact
COLLET NUT	1=Nut for fitting a bend relief

CABLE OD
10=OD: 1.0mm-1.2mm
15=OD: 1.3mm-1.5mm
20=OD: 1.6mm-2.0mm
25=OD: 2.1mm-2.5mm
30=OD: 2.6mm-3.0mm
35=OD: 3.1mm-3.5mm
40=OD: 3.6mm-4.0mm
45=OD: 4.1mm-4.5mm
50=OD: 4.6mm-5.0mm

CODE	KEY ANGLES
0	0°
A	30°
*	**

RoHS COMPLIANT	Unit:mm(inch)	PROJECTION	<b>ZCables.com</b>		PD./FILE NO.
	GENERAL TOLERANCES: (UNLESS SPECIFIED)	D.R. 11/06/2023			
	0 =±1 (0.039)	Philip	TITLE	OK Metal Series, 6 Pin, Plug, Male Contact, Straight, Solder, Snap Latch, IP50(Mating) Connector	
	0.0 =±.5 (0.02)	CH.K 11/06/2023	SCALE		
0.00 =±.3 (0.012)	Philip	SIZE	A4	REV. 01	
0.000=±.15(0.006)	APV.D 11/06/2023	SCALE	1:1	PART NO.	PZACFOKXA13061
0° =± 2'	Richard	SCALE	1:1	SHEET	1 OF 2
0.0° =± 1'					

THIS DRAWING AND THE DATA DISCLOSED HEREIN OR HEREWITH IS NOT TO BE REPRODUCED USED OR DISCLOSED IN WHOLE OR IN PART TO ANYONE WITHOUT THE PERMISSION OF JESS-LINK PRODUCTS CO.,LTD.(JPC)

CUSTOMER DRAWING  
DRWC-XXXXXX

REV.	ECN NO.	DESCRIPTION	MDF'D	APP'D	DATE
01		INITIAL DESIGN	Philip	Richard	11/06/2023
02					
03					

KEY ANGLES (PLUG FRONT VIEW) :

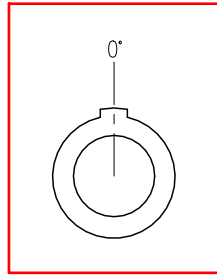

0

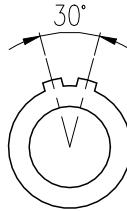

A

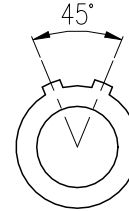

D

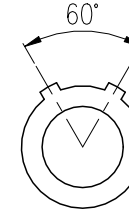

B

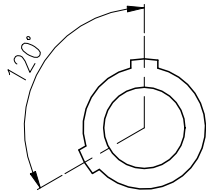

K

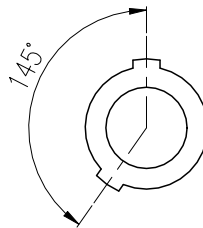

U

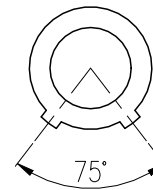

H

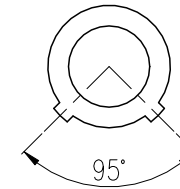

C

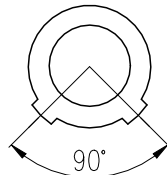

S

<b>RoHS COMPLIANT</b>	Unit:mm(inch)	PROJECTION 	<b>ZCables.com</b>		
	GENERAL TOLERANCES: (UNLESS SPECIFIED) 0 =±1 (0.039) 0.0 =±.5 (0.02) 0.00 =±.3 (0.012) 0.000=±.15(0.006) 0° =± 2° 0.0° =± 1°				TITLE OK Metal Series, 6 Pin, Plug, Male Contact, Straight, Solder, Snap Latch, IP50(Mating) Connector
	D.R. 11/06/2023 Philip	CH.K 11/06/2023 Philip	SCALE	SIZE	PART NO.
	APV.D 11/06/2023 Richard	1:1	A4	PZACFOKXA13061	REV. 01 SHEET 2 OF 2

PD./FILE NO.

REV. 01

SHEET 2 OF 2