

THIS DRAWING AND THE DATA DISCLOSED HEREIN OR HEREWITH IS NOT TO BE REPRODUCED USED OR DISCLOSED IN WHOLE OR IN PART TO ANYONE WITHOUT THE PERMISSION OF JESS-LINK PRODUCTS CO.,LTD.(JPC)

CUSTOMER DRAWING  
DRWC-XXXXXX

REV.	ECN NO.	DESCRIPTION	MDF'D	APP'D	DATE
01		INITIAL DESIGN	Philip	Richard	11/06/2023
02					
03					

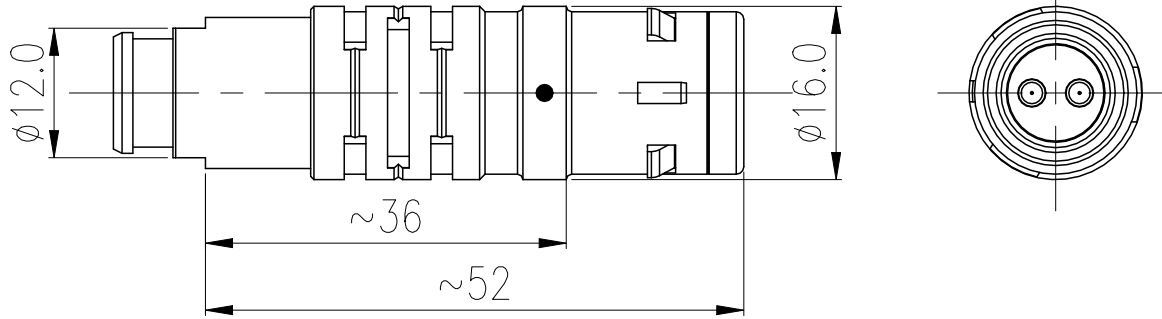

- NOTE:
- Material and finish  
Outer shell&Back nut: Copper alloy, Cr plating  
Contact: Copper alloy, Gold plating over Ni  
Insulator: PEEK UL94 V-1  
Gasket: FKM  
Other parts: Copper alloy, Ni plating
  - Mechanical characteristics  
Insertion Force: 34.3N MAX.  
Extraction Force: 34.3N MAX.  
Back nut torque: 2.0 N.m MAX.  
Endurance: 5000 mating cycles  
Vibration: 10-2000Hz , 15g comply with EIA-364-28  
Shock: 100g amplitude, half sine pulse of 3ms, no discontinuity > 1us EIA-364-27

PART NO: R - F 2 K S 2 6 0 2 C 1 0 8 5

CONTACT POS.		CABLE OD	
02-32=2pin-32pin		15=OD: 1.3mm-1.5mm	
SHELL MATERIAL		20=OD: 1.6mm-2.0mm	
0=Brass		25=OD: 2.1mm-2.5mm	
CODE	CONTACT TYPE	30=OD: 2.6mm-3.0mm	
2	Male Solder Contact	35=OD: 3.1mm-3.5mm	
4	Female Solder Contact	40=OD: 3.6mm-4.0mm	
C	Crimp Male Contact	45=OD: 4.1mm-4.5mm	
M	Crimp Female Contact	50=OD: 4.6mm-5.0mm	
COLLET NUT		55=OD: 5.1mm-5.5mm	
1=Nut for fitting a bend relief		60=OD: 5.6mm-6.0mm	
CODE	KEY ANGLES	65=OD: 6.1mm-6.5mm	
0	0°	70=OD: 6.6mm-7.0mm	
A	30°	75=OD: 7.1mm-7.5mm	
*	**	80=OD: 7.6mm-8.0mm	
		85=OD: 8.1mm-8.5mm	

- Electrical specifications  
Contact resistance: 8.7 mOhm MAX.  
After 5000 Cycles: 10 mOhm MAX.  
Insulation resistance: >100 Mohm  
Rated current: 2PIN 25.0A (Per Pin) 3PIN 17.0A(Per Pin)  
4PIN 15.0A (Per Pin) 5PIN 14.0A (Per Pin)  
6PIN 12.0A (Per Pin) 7PIN 11.0A (Per Pin)  
8PIN 10.0A (Per Pin) 10PIN 8.0A (Per Pin)  
12PIN 7.0A (Per Pin) 14PIN 6.5A (Per Pin)  
16PIN 6.0A (Per Pin) 18PIN 5.5A (Per Pin)  
19PIN 5.0A (Per Pin) 26PIN 2.0A (Per Pin)  
32PIN 1.5A (Per Pin)
- Characteristics  
Waterproof level: IP68 (Mating)  
Operating temperature: -55°C ~ + 200°C  
Corrosion resistance: 144 H salt mist, 5 % salt solution, 35°C  
Humidity: 21 days at 95% RH
- Max Wire Size (AWG) : #16 for 2pin #18 for 3pin  
#20 for 4~7pin #22 for 8&10pin  
#24 for 12~19pin #28 for 26&32pin
- RoHS compliance

RoHS COMPLIANT	Unit:mm(inch)	PROJECTION	<b>ZCables.com</b>		PD./FILE NO.
	GENERAL TOLERANCES: (UNLESS SPECIFIED)	D.R. 11/06/2023			
	0 =±1 (0.039)	Philip	TITLE	REV. 01	
	0.0 =±.5 (0.02)	CH.K 11/06/2023	2K Metal Series, 26 Pin, Plug, Male Contact, Straight, Solder, Snap Latch, IP50(Mating) Connector		
0.00 =±.3 (0.012)	Philip	SCALE	SIZE	PART NO.	SHEET 1 OF 3
0.000=±.15(0.006)	APV.D 11/06/2023	1:1	A4	PZACF2KXA19261	
0° =± 2'	Richard				
0.0° =± 1'					

THIS DRAWING AND THE DATA DISCLOSED HEREIN OR HEREWITH IS NOT TO BE REPRODUCED USED OR DISCLOSED IN WHOLE OR IN PART TO ANYONE WITHOUT THE PERMISSION OF JESS-LINK PRODUCTS CO.,LTD.(JPC)

CUSTOMER DRAWING  
DRWC-XXXXXX

REV.	ECN NO.	DESCRIPTION	MDF'D	APP'D	DATE
01		INITIAL DESIGN	Philip	Richard	11/06/2023
02					
03					

view from termination side pin part

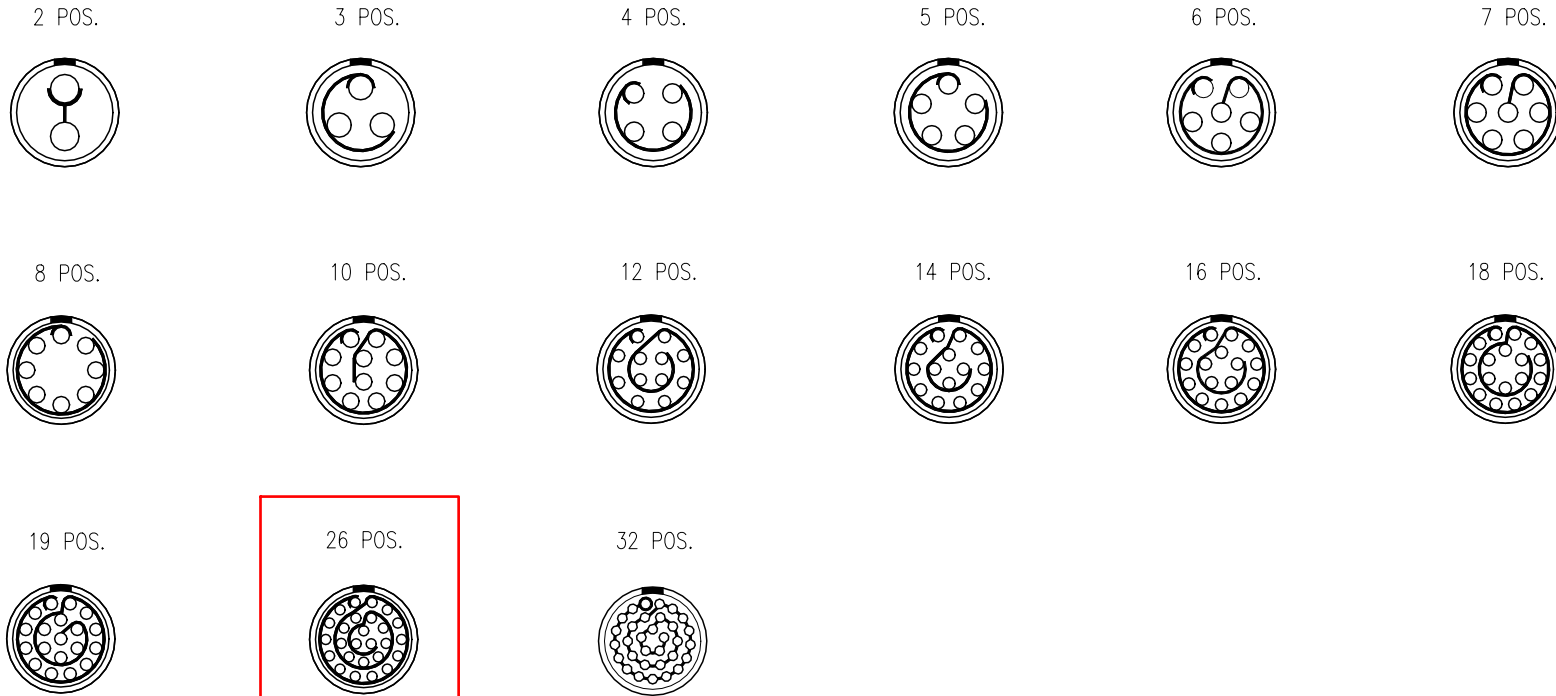

<b>RoHS COMPLIANT</b>	Unit:mm(inch)	PROJECTION 	<b>ZCables.com</b>	
	GENERAL TOLERANCES: (UNLESS SPECIFIED) 0 =±1 (0.039) 0.0 =±.5 (0.02) 0.00 =±.3 (0.012) 0.000=±.15(0.006) 0' =± 2' 0.0' =± 1'	D.R. 11/06/2023 Philip CH.K 11/06/2023 Philip APV.D 11/06/2023 Richard		
	SCALE	SIZE	PART NO.	REV. 01
	1:1	A4	PZACF2KXA19261	SHEET 2 OF 3

THIS DRAWING AND THE DATA DISCLOSED HEREIN OR HEREWITH IS NOT TO BE REPRODUCED USED OR DISCLOSED IN WHOLE OR IN PART TO ANYONE WITHOUT THE PERMISSION OF JESS-LINK PRODUCTS CO.,LTD.(JPC)

CUSTOMER DRAWING  
DRWC-XXXXXX

REV.	ECN NO.	DESCRIPTION	MDF'D	APP'D	DATE
01		INITIAL DESIGN	Philip	Richard	11/06/2023
02					
03					

KEY ANGLES (PLUG FRONT VIEW) :

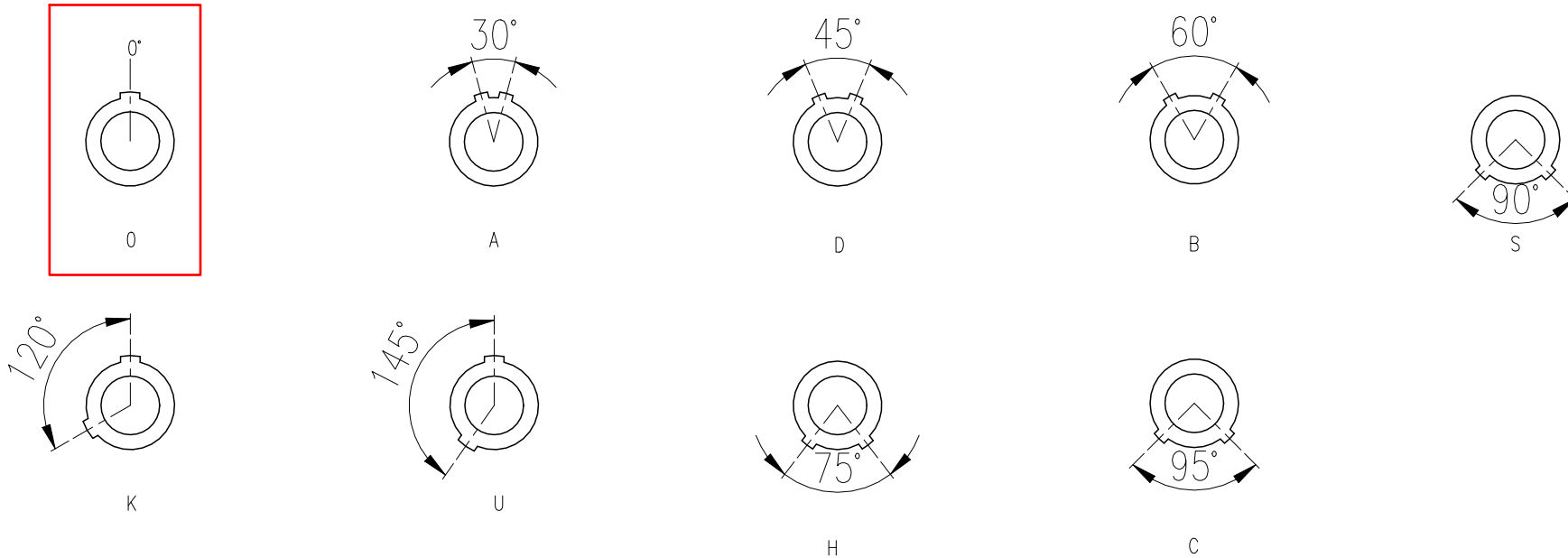

<b>RoHS COMPLIANT</b>	Unit:mm(inch)	PROJECTION 	<b>ZCables.com</b>		
	GENERAL TOLERANCES: (UNLESS SPECIFIED)				TITLE 2K Metal Series, 26 Pin, Plug, Male Contact, Straight, Solder, Snap Latch, IP50(Mating) Connector
	0 =±1 (0.039)	D.R. 11/06/2023 Philip	SCALE	SIZE	REV. 01
	0.0 =±.5 (0.02)	CH.K 11/06/2023 Philip	1:1	A4	PART NO. PZACF2KXA19261
0.000=±.15(0.006)	APV.D 11/06/2023 Richard			SHEET 2 OF 3	
0° =± 2'					
0.0° =± 1'					