

Cat.6A S/FTP 23AWG Solid Wires Cable

For RoHS

Material Specifications

- **Conductors** Bare copper, 23AWG, 1 x 0.56±0.005mm
- **Insulation** Skin-Foam-Skin, O.D. 1.33±0.03mm
- **Foil Screen** Aluminum / PET on each pair
- **Braid** Tinned copper-clad steel, min. 30% coverage
- **Drain wire** n/a
- **Jacket** 0.55mm thickness, O.D. 7.3±0.2mm
- **Separator** n/a

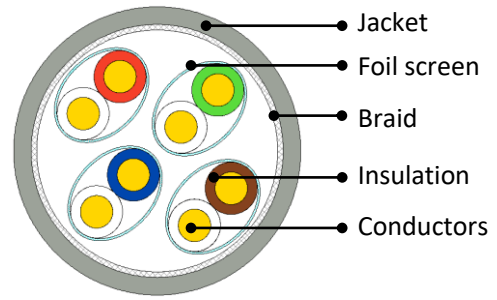

Printing on the cable

- **UL CM PVC** S/FTP INSTALL CABLE 23AWG 4PR E178558 C(UL)US TYPE CM 75°C ISO/IEC 11801 CLASS EA & EN50288 CAT.6A XXXXXXXX-X XXXM
- **UL CMR PVC** S/FTP INSTALL CABLE 23AWG 4PR E178558 C(UL)US TYPE CMR 75°C ISO/IEC 11801 CLASS EA & EN50288 CAT.6A XXXXXXXX-X XXXM
- **PVC** S/FTP INSTALL CABLE 23AWG 4PR PVC ISO/IEC 11801 CLASS EA & EN50288 CAT.6A XXXXXXXX-X XXXM
- **LSZH** S/FTP INSTALL CABLE 23AWG 4PR LSZH ISO/IEC 11801 CLASS EA & EN50288 CAT.6A XXXXXXXX-X XXXM

Installation Information

- **Installing temperature** 0°C to 50°C (32°F to 122°F)
- **Storage temperature** -40°C to 60°C (-40°F to 140°F), under static conditions
- **Operating temperature** -20°C to 60°C (-4°F to 140°F), under static conditions
- **Pulling tension** Max. 100N
- **Bend radius** Min. 29.2mm (4x of cable O.D.)
- **UL temperature rating** 75°C

Technical Data Sheet

For RoHS

Electrical Characteristics (IEC 61156-5)

• DC resistance	Max. 7.32Ω/100m for each conductor(UL444)
• DC resistance unbalance	Max. 2% within a pair at 20°C
• DC resistance unbalance pair-pair	n/a
• Dielectric strength	1kV d.c./0.7kV a.c. for 1min. or 2.5kV d.c./1.7kV a.c. for 2s
• Insulation resistance	5000MΩ/km
• Mutual capacitance	n/a
• Capacitance unbalance pair-ground	Max. 160pF/100m, 1kHz at 20°C
• Transfer impedance	Max. 100 mΩ/m at 100MHz, grade 1
• Coupling attenuation	Min. 35dB at 1GHz, type II
• Phase delay	Max. 536ns/100m at 500MHz
• Delay skew	Max. 45ns/100m, from 4 to 500MHz at 20°C
• Nominal velocity propagation	80% at 100MHz
• Characteristic Impedance	100±5Ω at 100MHz
• PoE	60Vd.c., 4PPoE 100W, IEEE802.3bt type 4
• UL voltage rating	300V(UL444)

Transmission performance (IEC61156-5, 100m, at 20°C)

Frequency MHz	Return loss Min. dB	Insertion loss Max. dB	NEXT Min. dB	PSNEXT Min. dB	ACRF Min. dB	PSACRF Min. dB	TCL Min. dB
*1	20.0	2.1	75.3	72.3	68.0	65.0	40.0
4	23.0	3.8	66.3	63.3	56.0	53.0	34.0
100	20.1	19.1	45.3	42.3	28.0	25.0	20.0
250	17.3	31.1	39.3	36.3	20.0	17.0	16.0
500	17.3	45.3	34.8	31.8	14.0	11.0	n/a

• For Information only

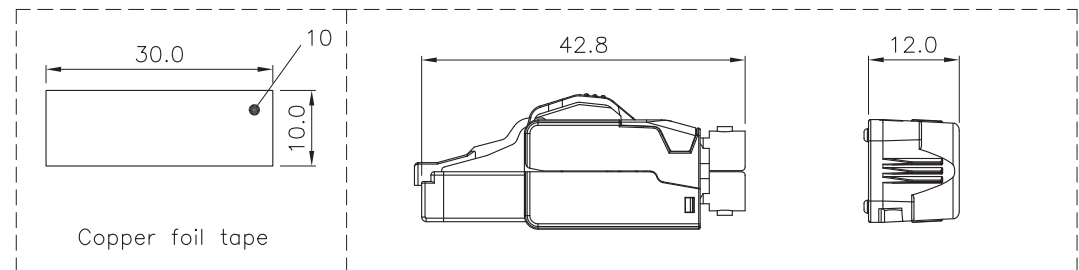
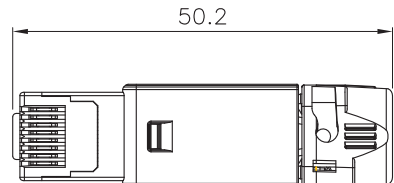
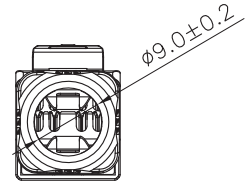
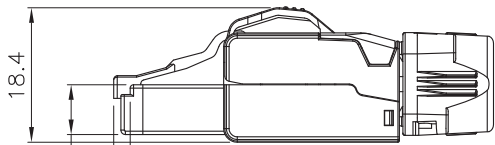
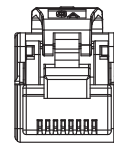
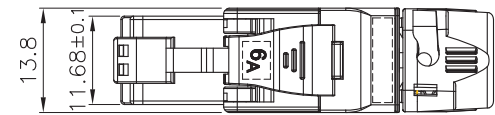
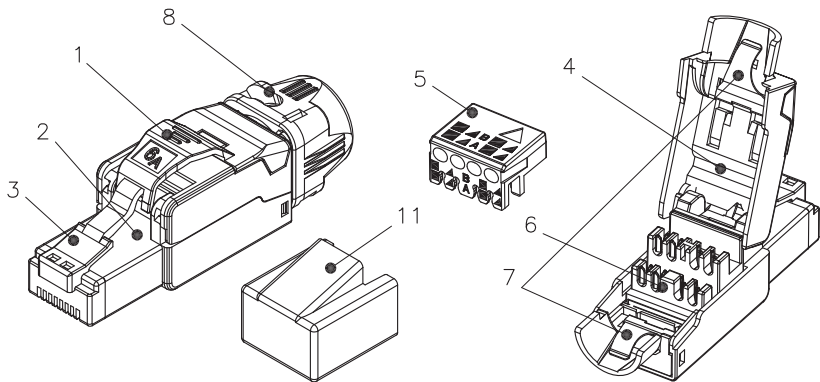

Specification :

Material :

1. Extractor : PC, UL94V-2, black color.
2. Housing : Zinc die-casting with nickel plating.
3. RJ45 plug :
 - 3-1. Housing : PC, UL94V-2, transparent yellow color.
 - 3-2. Contacts material : Phosphor bronze with nickel plating.
 - 3-3. Contacts gold plating: Min. 50 micro-inch gold plating on surface contact area.
4. Cover : Zinc die-casting with nickel plating.
5. Wire management bar : PC, UL94V-2, white color.
6. IDC :
 - 6-1. Housing : PC, UL94V-2, white color.
 - 6-2. Terminals : Copper-alloy with tin plating.
7. Grounding contacts : Copper with nickel plating.
8. PCB: UL94V-0.
8. Boot :
 - 8-1. Housing : Zinc die-casting with nickel plating.
 - 8-2. Cap : C3604.
9. PCB: UL94V-0.
10. Copper foil tape.
11. Dust cap : PE, black color.

Features and performance:

- a. Compliant with the IEC60603-7-1 dimension & reliability requirement.
 - b. T568A & T568B wiring.
 - c. Life (mating cycles): Min. 750 cycles.
 - d. Mating & un-mating force: Max. 30 N.
 - e. Retention strength: 7.7 kg between jack & plug.
 - f. Wire conductor range: Solid and stranded, 22-24AWG.
 - g. Cable OD range: 6.0-8.5mm.
 - h. IDC re-installing cycles: 22AWG: Max. 5 cycles.
23-24AWG: min. 20 cycles.
 - i. Operating temperature: -10°C to +60°C.
- Note: The mated jack should compliant with the IEC60603-7-1 requirement.

GENERAL TOLERANCE OF DIMENSIONS X.XXX ±0.1 X.XX ±0.2 X.X ±0.3	DRAWING	29.DEC.2022		ZCables	
	CHECK	29.DEC.2022			
	APPROVAL	29.DEC.2022		ITEM NO.: TNPACUUE0661721002	
		DATE		DES.: CAT.6A full shielded field termination plug	
SCALE	1/1 (A4)	UNIT	mm		
HSF Spec.	DRAWING NO. TNPACUUE0661721002		DRAWING CLASSIFICATION		
RoHS	DRAWING CLASSIFICATION				
		S	SHEET	1 OF 1	A2